



eloLance SL2D

A eloLance – a nova geração de lança de sucção

A eloLance é a nova geração de lança de sucção que lhe oferece tudo que você precisa para tornar seus sistemas e máquinas mais eficientes e reduzir sua carga de trabalho. Seu baixo ponto de extração permite o manuseio econômico e sustentável de líquidos e reduz as quantidades residuais no recipiente. Sua alta confiabilidade e resistência em uma ampla gama de líquidos, combinada com uma operação simples e segura, são fortes argumentos para os usuários. Isto faz das lanças de sucção a solução ideal para uso em latas.

Especificação Técnica

- Design sem selo
- Baixo ponto de extração
- Fácil manuseio devido à seção ergonômica da cabeça
- 1 ou 2 pontos de comutação possíveis: preventivo e ponto de comutação vazio
- Alta resistência devido à espessura otimizada da parede para componentes em contato com a mídia
- Cone de aperto para ajuste de altura variável
- Mangueira horizontal e saída do cabo
- Travão de escape de bola

Desenho técnico

IMAGE 1/6

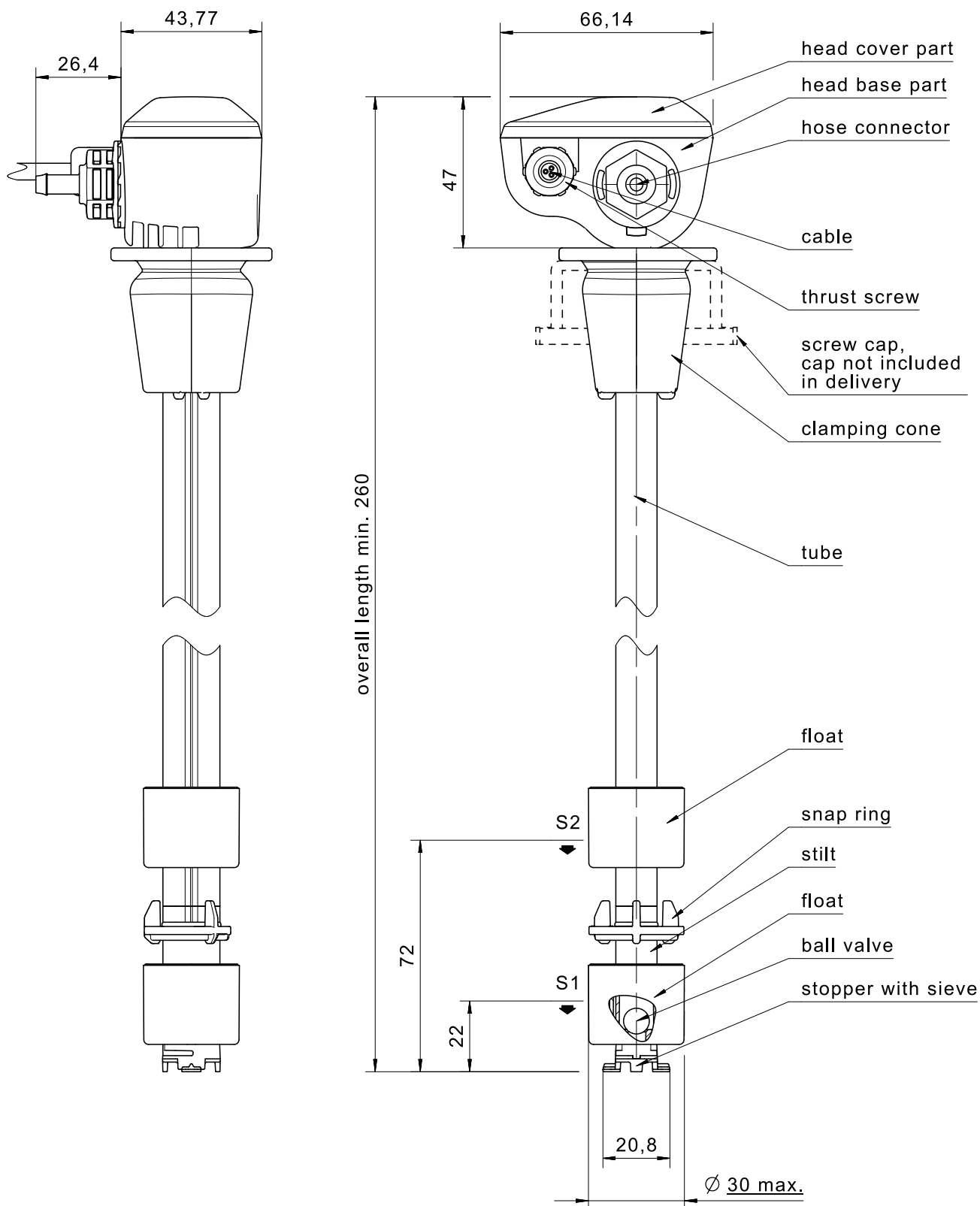

The diagrams illustrate four different switching functions for SF-A and SF-B based on the float cover position (1 or 2). The diagrams are arranged in a 2x2 grid. The top row shows SF-A (NO) and SF-B (NC) functions, and the bottom row shows SF-A (NC) and SF-B (NO) functions. The diagrams are labeled 1 and 2, corresponding to the float cover positions.

Diagram 1 (Top Left): SF-A (NO) and SF-B (NC) functions. The SF-A circuit is a normally open contact in series with a normally closed contact. The SF-B circuit is a normally open contact in series with a normally open contact.

Diagram 2 (Top Right): SF-A (NO) and SF-B (NC) functions. The SF-A circuit is a normally open contact in series with a normally open contact. The SF-B circuit is a normally open contact in series with a normally closed contact.

Diagram 3 (Bottom Left): SF-A (NC) and SF-B (NO) functions. The SF-A circuit is a normally closed contact in series with a normally open contact. The SF-B circuit is a normally closed contact in series with a normally open contact.

Diagram 4 (Bottom Right): SF-A (NC) and SF-B (NO) functions. The SF-A circuit is a normally closed contact in series with a normally closed contact. The SF-B circuit is a normally closed contact in series with a normally closed contact.

IMAGE 3/6

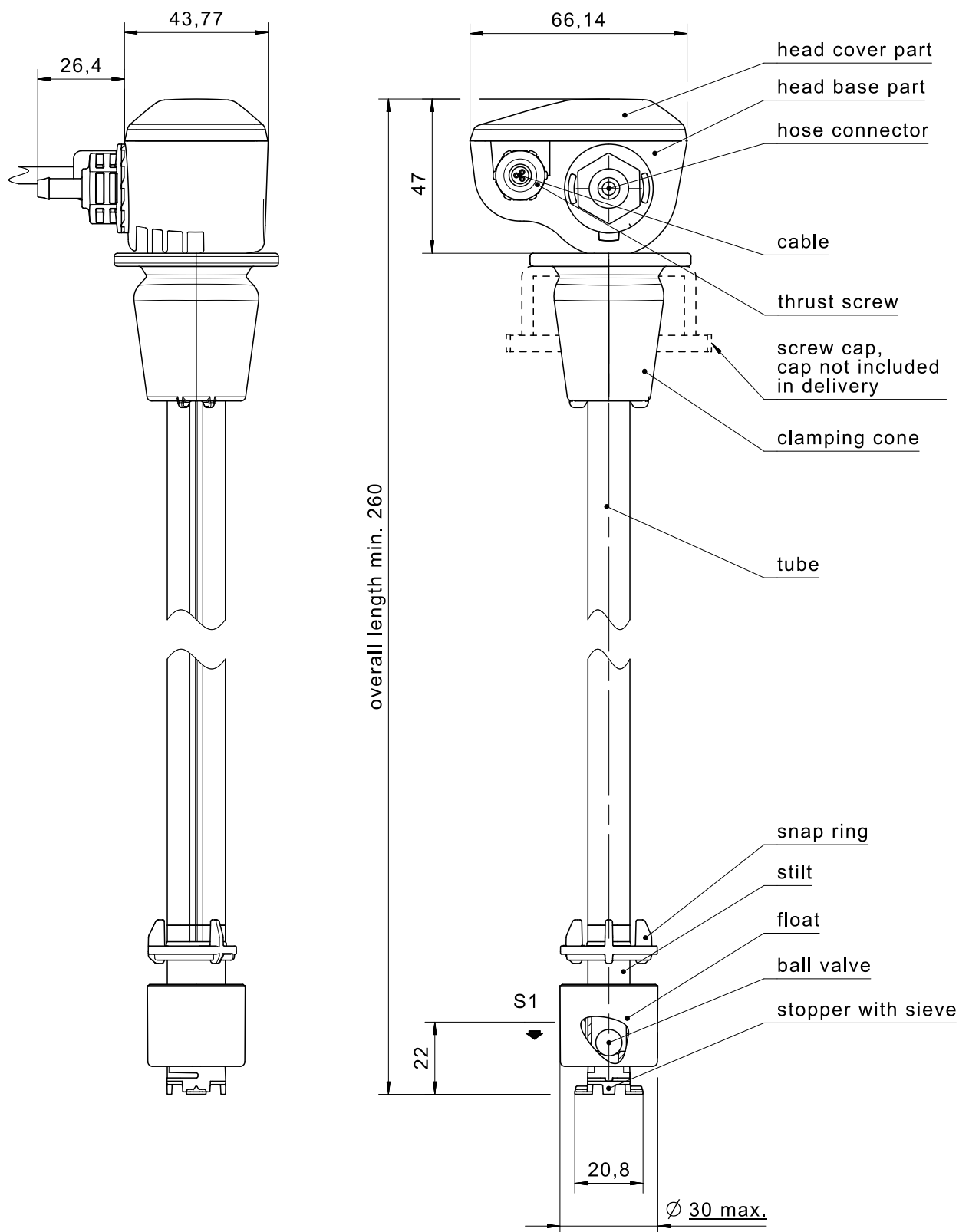

IMAGE 4/6

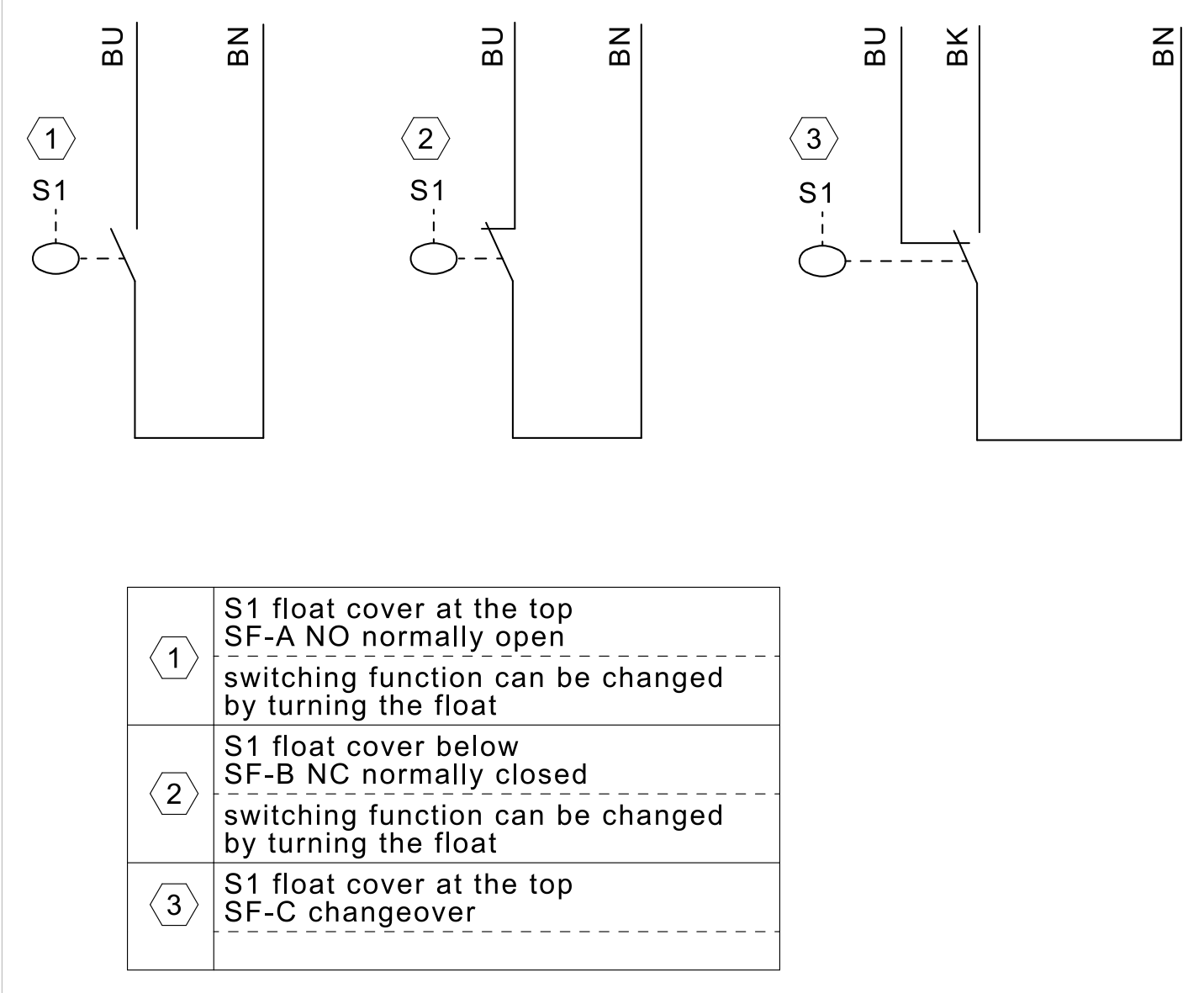

IMAGE 5/6

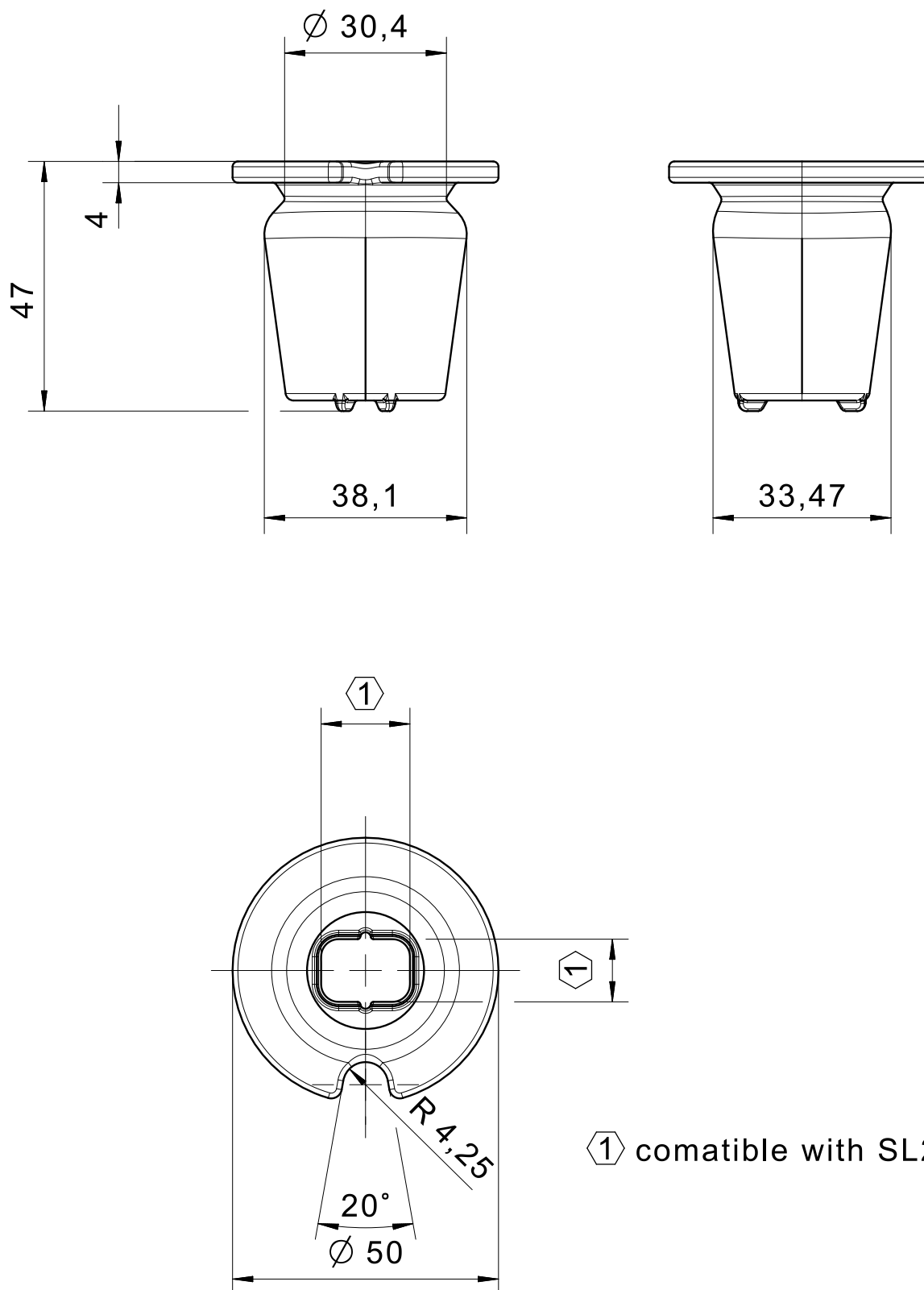
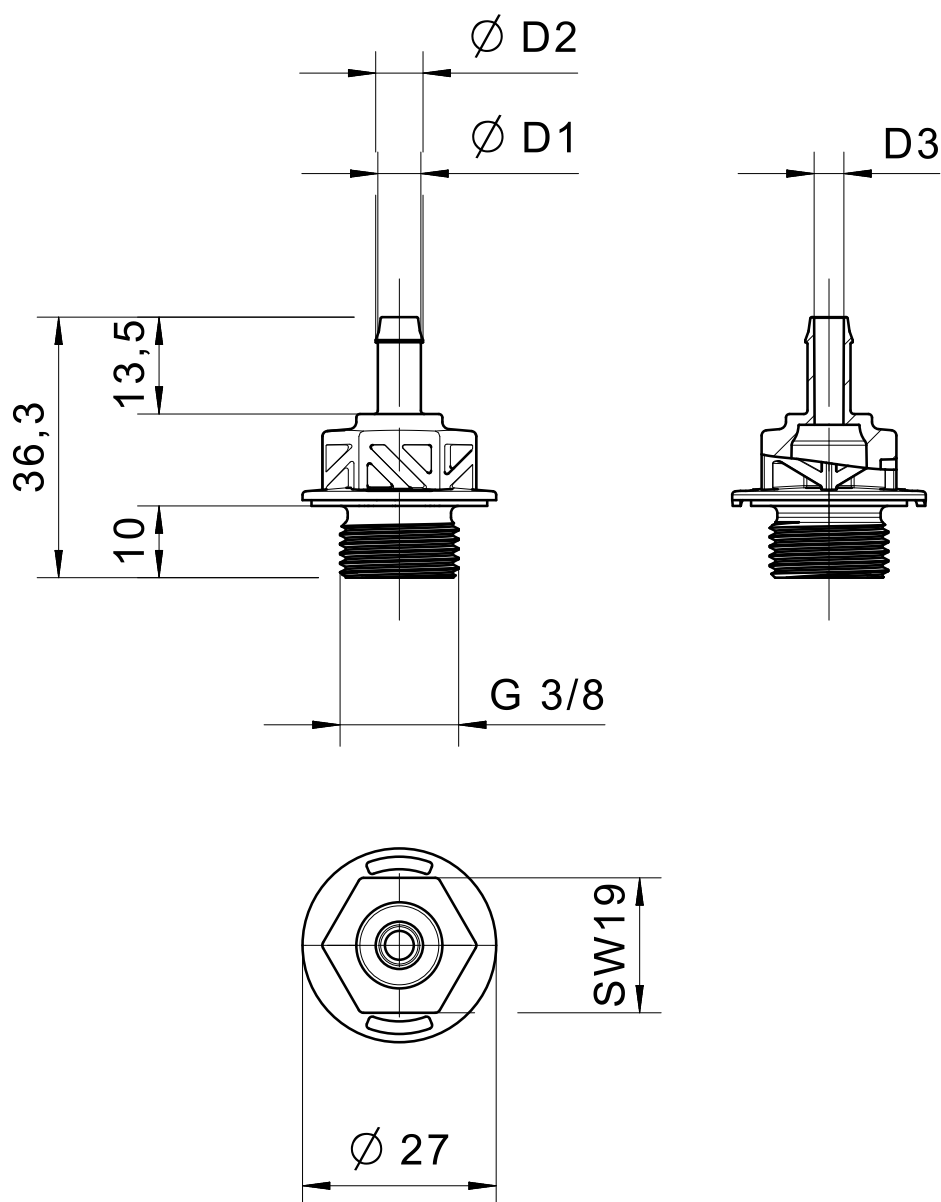

IMAGE 6/6



D1	D2	D3
Ø4	4,5	2
Ø6	6,6	4
Ø8	8,7	6

Características do artigo

Attribute	SL2D1000010	SL2D1000011	SL2D1000012	SL2D1000013	SL2D1000014	SL2D1000015 ▶
Max. switching voltage	48 V AC					
Max. switching voltage	48 V DC					
Max. switching current	0.5 A					
Max. switching power	10 VA					
Output signal	digital					
Technology	Reed					
Number of switching points	1					
Contact form S1	opens at falling level					
Contact form S2	-					
Switching point height S1	22 mm					
Switching point height S2	-					
Run-out brake	Gravity ball brake					
Filter sieve	Filter mesh size 50 x 0,89mm ²					
Article marking	Laser marking					
Structure	Seal free structure in immersed area					
Overall length	260 mm	300 mm	340 mm	400 mm	440 mm	500 mm
Immersion length max.	209 mm	249 mm	289 mm	349 mm	389 mm	449 mm
Height/Width/Depth head piece	47mm x 66,14mm x 43,77mm					
Float diameter	30 mm					
Recommended minimum density of the medium	0.7 g/cm ³					
Housing material	PP/PVC/TPE					
Float material	PE					
Hose fitting material	PE					
Riser material	PVC					
Sealing ring material	-					
Cable material	PVC					
Hose material	-					
Valve ball material	Glass					
Container fastening material	Silicone					
Protection class head piece	IP65 DIN EN 60529					

Características do artigo

Attribute	SL2D1000010	SL2D1000011	SL2D1000012	SL2D1000013	SL2D1000014	SL2D1000015 ▶
Protection class below head piece	IPX8 DIN EN 60529					
Operating temperature min.	5 °C					
Max. operating temperature	60 °C					
Min. storage temperature	-20 °C					
Max. storage temperature	60 °C					
Connection/outlets	Hose fitting for hose with inner diameter 6 mm					
Installation opening	min. 30mm					
Mounting type	Clamping cone					
Connector type	-					
Cable length	5 m					
Connection type	End splice					
Cable type	2x0,50mm² PVC LiYYöw/UL					

Características do artigo

Attribute	SL2D1000016	SL2D2000008	SL2D2000009	SL2D2000011	SL2D2000013	SL2D2000014 ▶
Max. switching voltage	48 V AC					
Max. switching voltage	48 V DC					
Max. switching current	0.5 A	0.25 A				
Max. switching power	10 VA	5 VA				
Output signal	digital					
Technology	Reed					
Number of switching points	1	2				
Contact form S1	opens at falling level					
Contact form S2	-	opens at falling level				
Switching point height S1	22 mm					
Switching point height S2	-	72 mm				
Run-out brake	Gravity ball brake					
Filter sieve	Filter mesh size 50 x 0,89mm²					
Article marking	Laser marking					
Structure	Seal free structure in immersed area					
Overall length	600 mm	300 mm	400 mm	600 mm	440 mm	340 mm
Immersion length max.	549 mm	249 mm	349 mm	549 mm	389 mm	289 mm
Height/Width/Depth head piece	47mm x 66,14mm x 43,77mm					
Float diameter	30 mm					
Recommended minimum density of the medium	0.7 g/cm³					
Housing material	PP/PVC/TPE					
Float material	PE					
Hose fitting material	PE					
Riser material	PVC					
Sealing ring material	-					
Cable material	PVC					
Hose material	-					
Valve ball material	Glass					
Container fastening material	Silicone					
Protection class head piece	IP65 DIN EN 60529					

Características do artigo

Attribute	SL2D1000016	SL2D2000008	SL2D2000009	SL2D2000011	SL2D2000013	SL2D2000014 ▶
Protection class below head piece	IPX8 DIN EN 60529					
Operating temperature min.	5 °C					
Max. operating temperature	60 °C					
Min. storage temperature	-20 °C					
Max. storage temperature	60 °C					
Connection/outlets	Hose fitting for hose with inner diameter 6 mm					
Installation opening	min. 30mm					
Mounting type	Clamping cone					
Connector type	-					
Cable length	5 m					
Connection type	End splice					
Cable type	2x0,50mm² PVC LiYYöw/UL	3x0,50mm² PVC LiYYöw/UL				

Características do artigo

Attribute	SL2D2000015	SL2D2000016	SL2D1000006	SL2D1000007	SL2D1000008	SL2D1000009 ▶
Max. switching voltage	48 V AC					
Max. switching voltage	48 V DC					
Max. switching current	0.25 A		0.5 A			
Max. switching power	5 VA		10 VA			
Output signal	digital					
Technology	Reed					
Number of switching points	2		1			
Contact form S1	opens at falling level					
Contact form S2	opens at falling level		-			
Switching point height S1	22 mm					
Switching point height S2	72 mm		-			
Run-out brake	Gravity ball brake					
Filter sieve	Filter mesh size 50 x 0,89mm²					
Article marking	Laser marking					
Structure	Seal free structure in immersed area					
Overall length	260 mm	1200 mm	440 mm	500 mm	600 mm	800 mm
Immersion length max.	209 mm	1149 mm	389 mm	449 mm	549 mm	749 mm
Height/Width/Depth head piece	47mm x 66,14mm x 43,77mm					
Float diameter	30 mm					
Recommended minimum density of the medium	0.7 g/cm³					
Housing material	PP/PVC/TPE					
Float material	PE					
Hose fitting material	PE					
Riser material	PVC					
Sealing ring material	-					
Cable material	PVC					
Hose material	-					
Valve ball material	Glass					
Container fastening material	Silicone					
Protection class head piece	IP65 DIN EN 60529					

Características do artigo

Attribute	SL2D2000015	SL2D2000016	SL2D1000006	SL2D1000007	SL2D1000008	SL2D1000009 ▶
Protection class below head piece	IPX8 DIN EN 60529					
Operating temperature min.	5 °C					
Max. operating temperature	60 °C					
Min. storage temperature	-20 °C					
Max. storage temperature	60 °C					
Connection/outlets	Hose fitting for hose with inner diameter 6 mm					
Installation opening	min. 30mm					
Mounting type	Clamping cone					
Connector type	-					
Cable length	5 m		3 m			
Connection type	End splice					
Cable type	3x0,50mm² PVC LiYYöw/UL		2x0,50mm² PVC LiYYöw/UL			

Características do artigo

Attribute	SL2D2000003	SL2D2000006	SL2D2000007	SL2D1000004	SL2D2000004	SL2D2000005 ▶
Max. switching voltage	48 V AC					
Max. switching voltage	48 V DC					
Max. switching current	0.25 A			0.5 A	0.25 A	
Max. switching power	5 VA			10 VA	5 VA	
Output signal	digital					
Technology	Reed					
Number of switching points	2			1	2	
Contact form S1	opens at falling level					
Contact form S2	opens at falling level			-	opens at falling level	
Switching point height S1	22 mm					
Switching point height S2	72 mm			-	72 mm	
Run-out brake	Gravity ball brake			Schwerkraft-Kugel-Bremse	Gravity ball brake	
Filter sieve	Filter mesh size 50 x 0,89mm²			Sieb Maschenweite 50 x 0,89mm²	Filter mesh size 50 x 0,89mm²	
Article marking	Laser marking			Laserbeschriftet	Laser marking	
Structure	Seal free structure in immersed area			Dichtungs-freier Aufbau im eingetauchten Bereich	Seal free structure in immersed area	
Overall length	300 mm	600 mm	800 mm	340 mm	400 mm	500 mm
Immersion length max.	249 mm	549 mm	749 mm	289 mm	349 mm	449 mm
Height/Width/Depth head piece	47mm x 66,14mm x 43,77mm					
Float diameter	30 mm					
Recommended minimum density of the medium	0.7 g/cm³					
Housing material	PP/PVC/TPE					
Float material	PE					
Hose fitting material	PE					
Riser material	PVC					
Sealing ring material	-					
Cable material	PVC					
Hose material	-					

Características do artigo

Attribute	SL2D2000003	SL2D2000006	SL2D2000007	SL2D1000004	SL2D2000004	SL2D2000005 ▶
Valve ball material	Glass			Glas	Glass	
Container fastening material	Silicone			Silikon	Silicone	
Protection class head piece	IP65 DIN EN 60529					
Protection class below head piece	IPX8 DIN EN 60529					
Operating temperature min.	5 °C					
Max. operating temperature	60 °C					
Min. storage temperature	-20 °C					
Max. storage temperature	60 °C					
Connection/outlets	Hose fitting for hose with inner diameter 6 mm					
Installation opening	min. 30mm					
Mounting type	Clamping cone					
Connector type	-					
Cable length	3 m					
Connection type	End splice			Aderendhülse	End splice	
Cable type	3x0,50mm² PVC LiYYöw/UL			2x0.5mm² PVC LiYYöw/UL	3x0,50mm² PVC LiYYöw/UL	

Características do artigo

Attribute	SL2D2000010
Max. switching voltage	48 V AC
Max. switching voltage	48 V DC
Max. switching current	0.25 A
Max. switching power	5 VA
Output signal	digital
Technology	Reed
Number of switching points	2
Contact form S1	opens at falling level
Contact form S2	opens at falling level
Switching point height S1	22 mm
Switching point height S2	72 mm
Run-out brake	Gravity ball brake
Filter sieve	Filter mesh size 50 x 0,89mm ²
Article marking	Laser marking
Structure	Seal free structure in immersed area
Overall length	500 mm
Immersion length max.	449 mm
Height/Width/Depth head piece	47mm x 66,14mm x 43,77mm
Float diameter	30 mm
Recommended minimum density of the medium	0.7 g/cm ³
Housing material	PP/PVC/TPE
Float material	PE
Hose fitting material	PE
Riser material	PVC
Sealing ring material	-
Cable material	PVC
Hose material	-
Valve ball material	Glass
Container fastening material	Silicone
Protection class head piece	IP65 DIN EN 60529
Protection class below head piece	IPX8 DIN EN 60529

Características do artigo

Attribute	SL2D2000010
Operating temperature min.	5 °C
Max. operating temperature	60 °C
Min. storage temperature	-20 °C
Max. storage temperature	60 °C
Connection/outlets	Hose fitting for hose with inner diameter 6 mm
Installation opening	min. 30mm
Mounting type	Clamping cone
Connector type	-
Cable length	5 m
Connection type	End splice
Cable type	3x0,50mm² PVC LiYYöw/UL