



Magnetic sensor 153

Product characteristics

- Flat magnetic sensor on reed-contact basis
- PA housing
- 26 x 36 x 13 mm
- PVC cable

Technical drawing

IMAGE 1/1

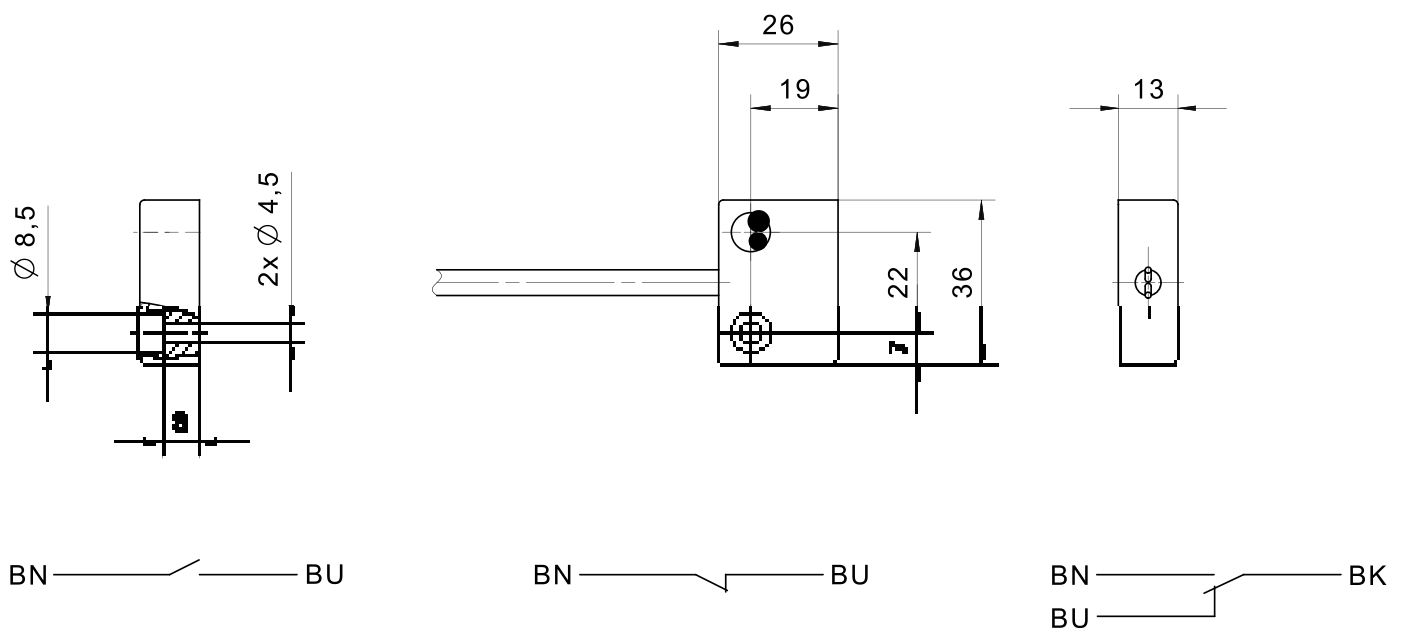

Product options

IMAGE 1/2

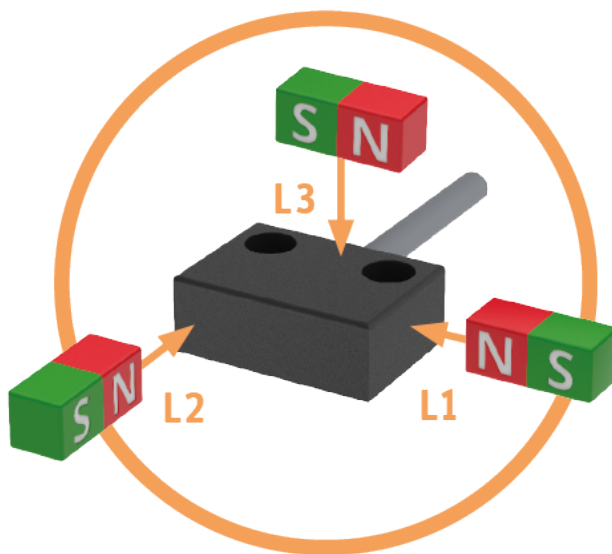

TYPICAL SWITCHING DISTANCES

| | 153210 | | | 153220 | | | 153230 | | |
|-----------|--------|-------|-------|--------|-------|-------|--------|-------|-------|
| ACTUATORS | L1 | L2 | L3 | L1 | L2 | L3 | L1 | L2 | L3 |
| 324790 | 13 mm | 6 mm | - | 10 mm | 5 mm | - | 11 mm | 12 mm | 9 mm |
| 300790 | 17 mm | 9 mm | mm | 13 mm | 7 mm | 6 mm | 15 mm | 15 mm | 13 mm |
| 300780 | 25 mm | 12 mm | 13 mm | 22 mm | 12 mm | 13 mm | 23 mm | 20 mm | 20 mm |

Further actuators and switching distances on request

IMAGE 2/2

ORDERING KEY

| 153 | | | Flat switch, reed contact |
|-----|-----|-----|---|
| | 210 | | N.O. – cable connection 1 m |
| | 220 | | N.C. – cable connection 1 m |
| | 230 | | C.O. – cable connection 1 m |
| | | | Other electrical data, housing with LED, on request |
| | | | |
| | | | Other available cable lengths |
| | | -3 | 3 m |
| | | -5 | 5 m |
| | | -10 | 10 m |
| | | | Other cable materials and cable lengths on request |

Article characteristics

| Attribute | 153210 | 153220 | 153230 |
|--|-------------------|--------|--------|
| Max. switching voltage | 48 V DC | | |
| Max. switching voltage | 48 V AC | | |
| Max. switching current | 0.5 A | | 1 A |
| Max. switching power | 10 W | | |
| Contact form | NO | NC | CO |
| Technology | Reed | | |
| LED display | No | | |
| Actuation | arbitrary | | |
| Switching principle | magnetic | | |
| Dimensions | 36x26x13 | | |
| Housing design | cuboid | | |
| Housing material | PA6 | | |
| Cable material | PVC | | |
| Protection class | IP67 DIN EN 60529 | | |
| Operating temperature min. | -25 °C | | |
| Max. operating temperature | 70 °C | 75 °C | |
| Min. storage temperature | -25 °C | | |
| Max. storage temperature | 70 °C | | 75 °C |
| Min. cable temperature range, moving | -5 °C | | -15 °C |
| Max. cable temperature range, moving | 70 °C | | 80 °C |
| Min. cable temperature range, fixed installation | -25 °C | | -40 °C |
| Max. cable temperature range, fixed installation | 70 °C | | 80 °C |
| Mounting type | screwed | | |
| Cable length | 1 m | | |