



SEKO magnet 324102 Ø8x17mm

Product characteristics

- For use with magnetic sensors
- Simple installation thanks to M6 thread
- Large temperature range

Technical drawing

IMAGE 1/1

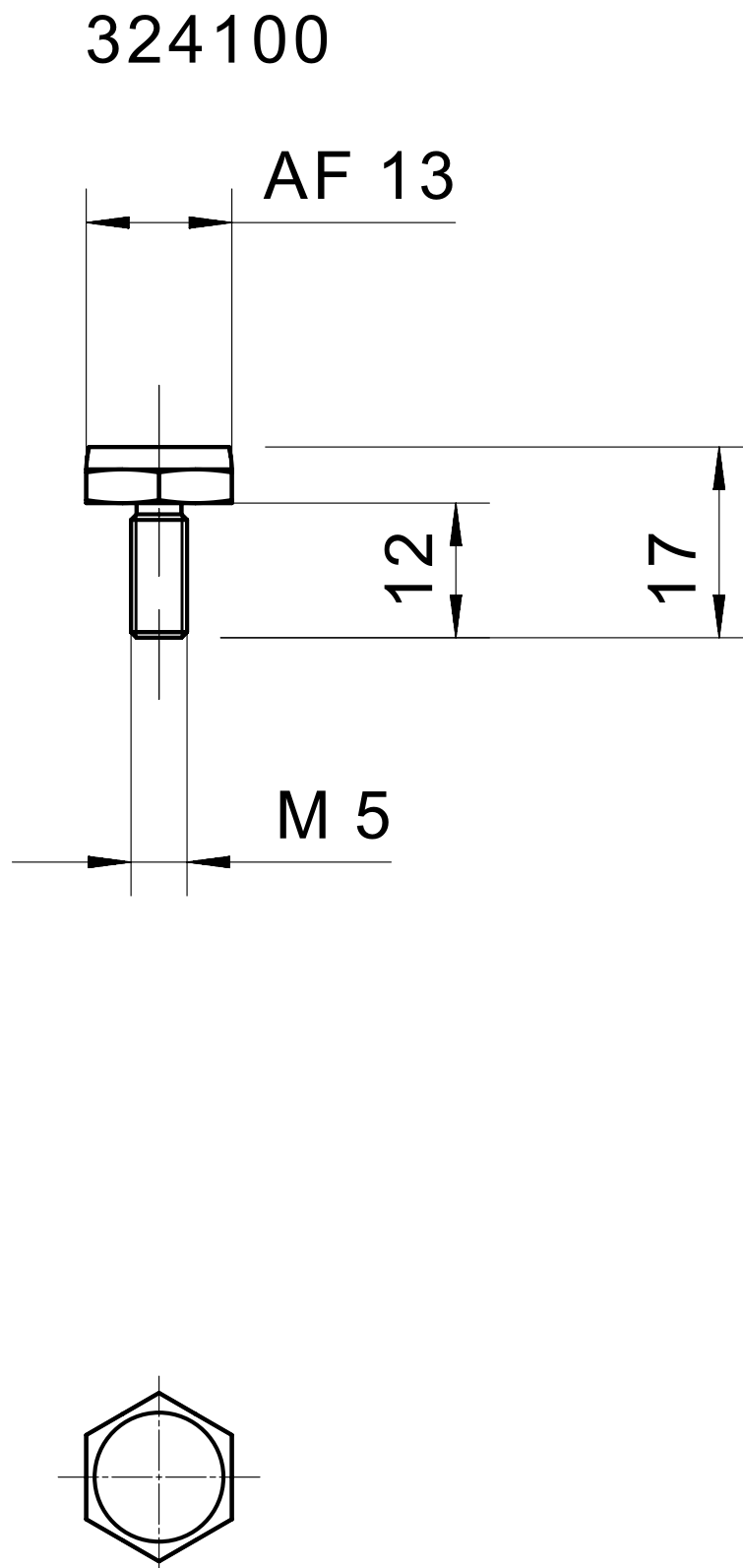

Article characteristics

| Attribute | 324102 |
|----------------------------|------------------------|
| Dimensions | SW10 / H=5 |
| Material | Galvanised steel, SmCo |
| Operating temperature min. | -20 °C |
| Max. operating temperature | 80 °C |
| Mounting type | Thread |
| Thread | M6x12 |